

Grant Volumiser Technical Specifications

30 litre volumiser

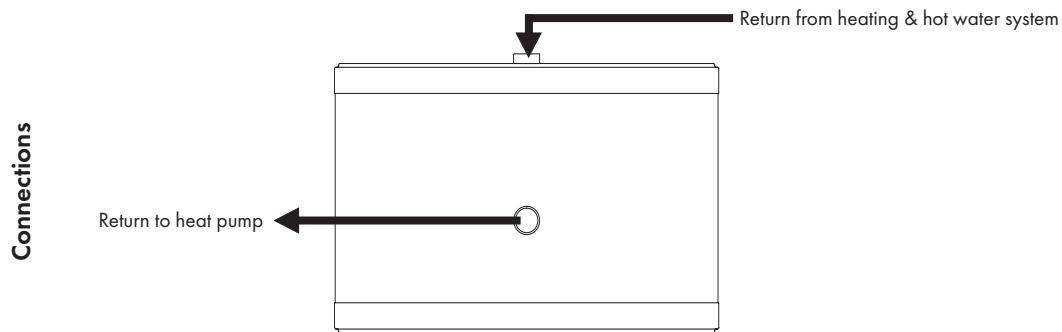
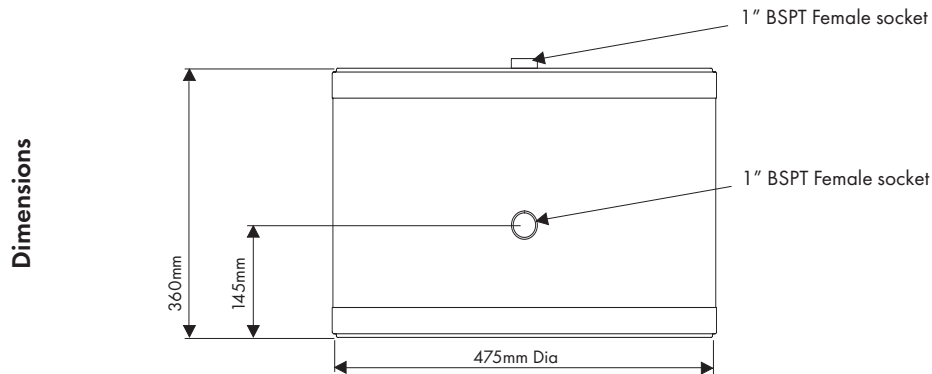

Note: Volumiser should be fitted in the return pipe to the Heat Pump (see schematic diagram on reverse).

Height (mm)		360
Diameter (mm)		475
Weight (kg)	Empty	8
	Full	41.5
Capacity (actual) (L)		33.5
Connections (BSP)		1" (2 off)
Max system operating pressure (bar)		3

Materials

Shell	Stainless steel (duplex 2034)
Outer casing	Steel (acrylic coated)
Top/bottom caps	ABS (acrylic capped)
Insulation	Polyurethane foam (40mm thick nominal) GWP<3 ODP=3

Grant Volumiser Technical Specifications

ASHP with volumiser schematic

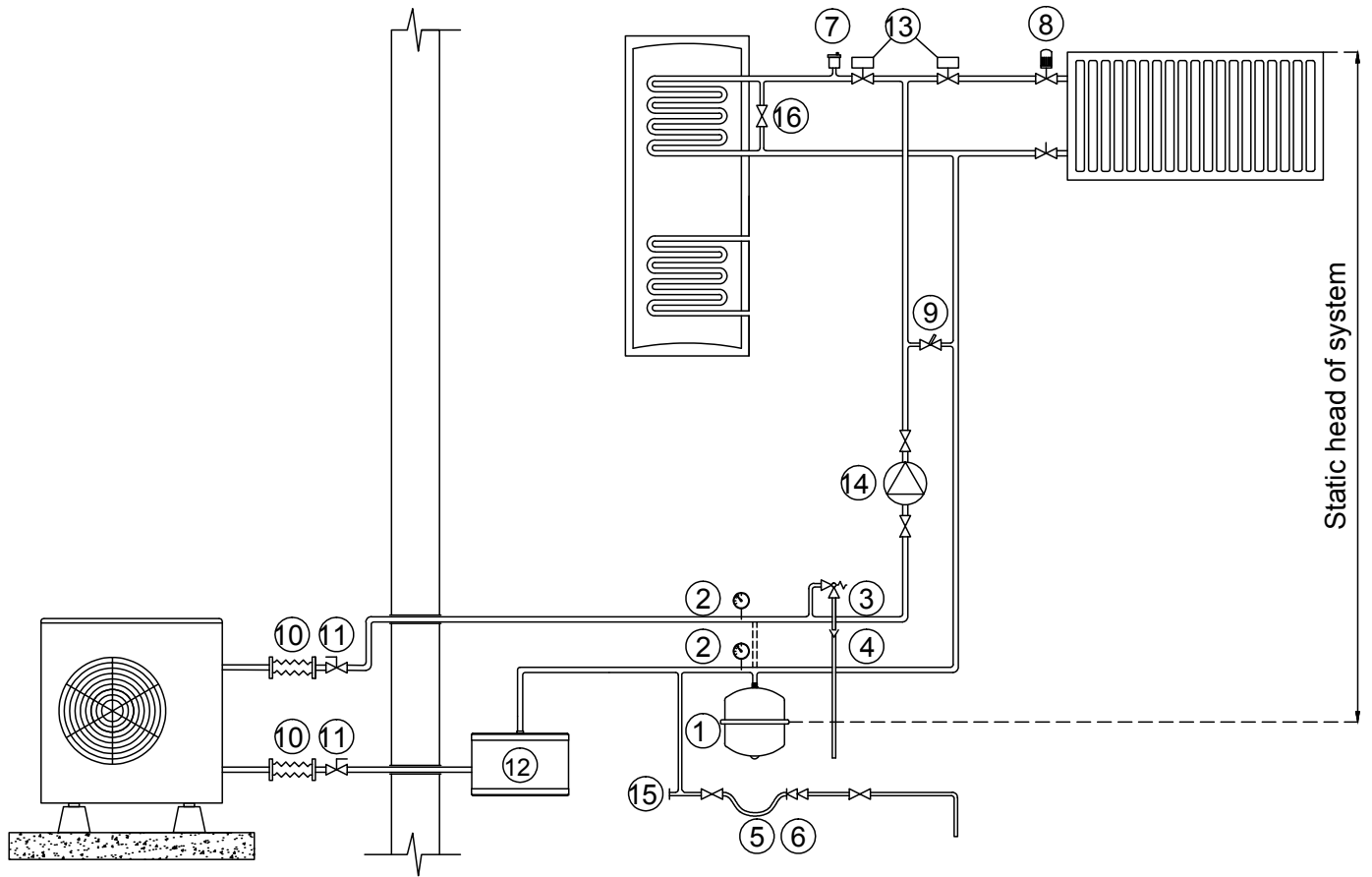

Key	Description	Key	Description
1	Expansion vessel	9	Automatic bypass
2	Pressure gauge	10	Flexible hose
3	Pressure relief valve	11	Isolation valve
4	Tundish	12	Volumiser
5	Removable filling loop	13	Motorised 2-port valve
6	Double check valve	14	Additional circulating pump (optional)
7	Automatic air vent	15	Drain point
8	Thermostatic radiator valve	16	Bypass - 16kW ASHP (HPID16) model only